

COOEE
ART LEVEN

ESTD 1981

VENUE HIRE PACKAGE

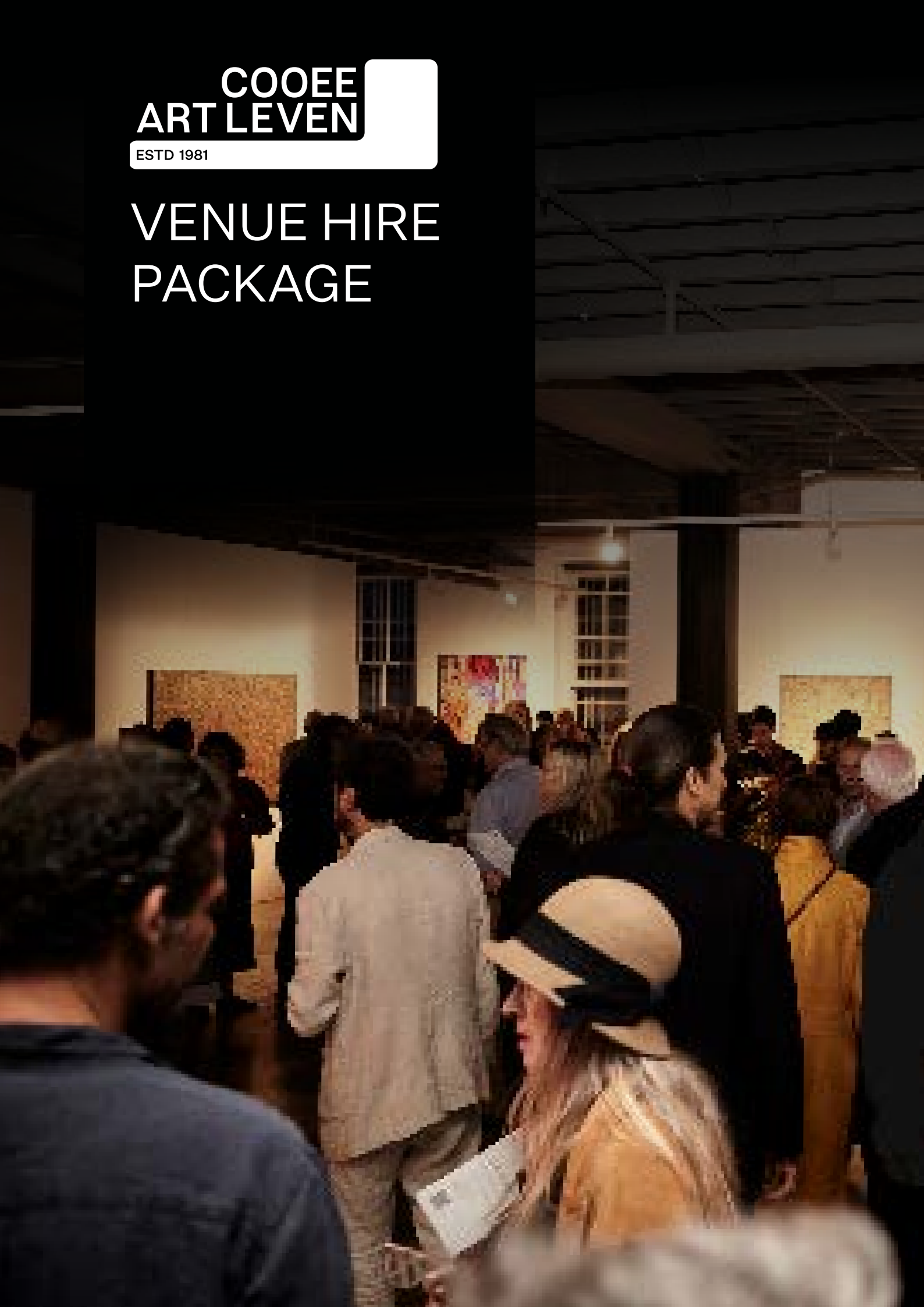



COOEE ART LEVEN

ESTD 1981

VENUE HIRE PACKAGE

VENUE OVERVIEW

Coee Art Leven is the ideal venue for hosting corporate and private functions. Our expansive 480m² gallery is in the heart of Aboriginal Sydney, Redfern.

The gallery occupies the ground floor of a distinctive and prominently located building only minutes from Surry Hills, Redfern, and Waterloo's art districts. Originally the headquarters and state-of-the-art factory of Foster Clark custard, 17 Thurlow St later became the studio and assembly for iconic Australian artist Ken Done. The space has been designed with a modern aesthetic whilst retaining elements of its past. A blank canvas, the space offers versatility to cater for a variety of purposes – including private events, art exhibitions, launch events, photo shoots, or performances.

Established in 1981, the gallery is an important cultural destination in Sydney. Coee Art Leven runs a hybrid art model to represent and support artists in an ethical and forward-propelling way, offering a unique and informative insight into the world of Australian Indigenous art. The venue has a neutral interior, natural light, movable walls, gallery lighting, art track hanging system and driveway access for easy bump in & out.

LOCATION

Ground Floor
17 Thurlow Street
Redfern NSW 2016

CONTACT

Hayley Cotton
Gallery Manager
gallery@artleven.com

+61 (02) 9300 9233
www.artleven.com.au
[@art.leven](https://www.instagram.com/art.leven)
[#cooeartleven](https://www.facebook.com/cooeartleven)

GALLERY SPACES & SPECIFICATIONS

	size	standing capacity	wall height	lighting height
Galleries 1 & 2	240 m ²	250 people	365 cm	300 cm
Gallery 2	49 m ²	50 people	365 cm	300 cm

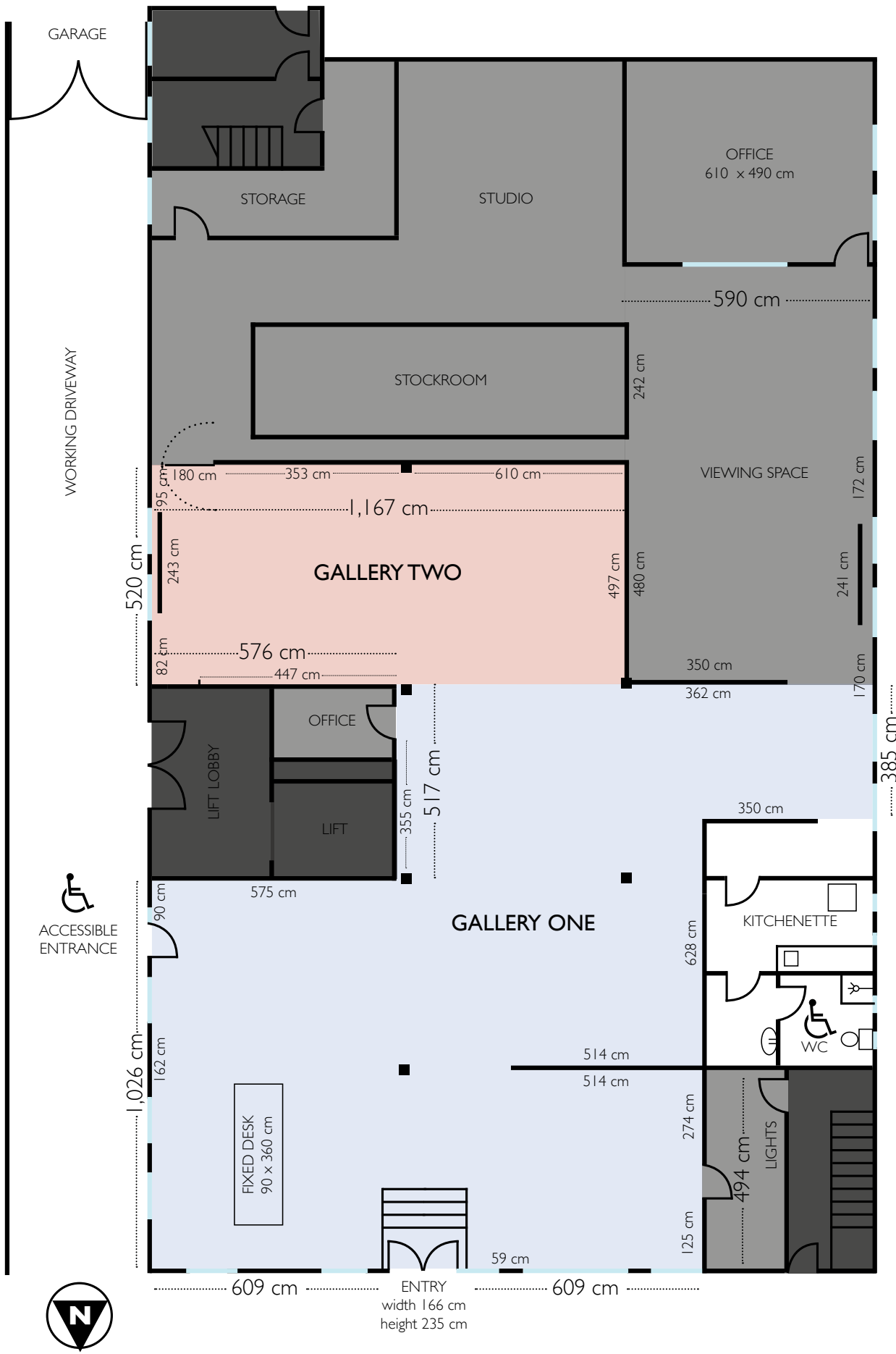

VENUE FLOORPLAN

* walls with sizes indicate the walls where items can be displayed

INCLUSIONS

Kitchenette | Microwave, sink and bench space where drinks and food may be prepared

Serving Boards | A variety of rustic grazing board accompaniments

Gallery Walls | Both Gallery I and II are perfect to display pictures or products

Reception Desk | 360 x 80 cm polished concrete tabletop, perfect for serving food/drinks or greeting guests

Bar Fridge | Easily movable bar fridge to accompany drinks station

Sonos Sound System | Accessible by Wifi

Lighting | The gallery lighting is fully adjustable according to your needs

Cleaning | Basic cleaning included before and after event of surfaces, bathroom, floors and rubbish removal

ADD ONS

INTERNAL SERVICES

Glassware | Both white wine (x90) and high ball glasses (x90) | \$250 (incl. cleaning)

Secure Garage Parking | If required, one parking spot is available | \$100/day

Art Talk/Discussion | 5 - 20 minute (your choice on length) by a senior staff member about the artworks and or Indigenous Art in general | \$350

Gallery Staff | If you require expert gallery staff to help install or set up your event or exhibition
Apply for rates



ADD ONS

EXTERNAL SERVICES

Catering | Catering can be organised and managed by your team, keeping in mind that there is no stove or oven in the kitchenette.

Alcohol | Alcohol can be served and delivered the day before the event and will be chilled as required and/or requested (at no additional cost). Alcohol must be free and not for sale.

Wait/Bar Staff | Wait or bar staff must be organised and managed by your team.

Furniture/Props | Limited chairs and tables are available. However, you will need to organise any further furniture externally. We are available to sign for delivery within our opening hours (no more than 24 hr before the hire date).

Artwork Storage | We have an available storage bay for any artworks to be exhibited.

Deep Cleaning | If you require a deeper clean before or after





size	240 m2
standing capacity	250 people
wall height	365 cm
lighting height	300 cm

GALLERY ONE & TWO

EVENT VENUE HIRE

TIMING & COST

Tuesday - Friday	4.00pm - 12.00am
4 Hour Duration	\$5,000
8 Hour Duration	\$8,000
Bump-in & Bump-out	\$1,200/hour (if extra time required)
Saturday	4.00pm - 12.00am
4 Hour Duration	\$6,000
8 Hour Duration	\$9,600
Bump-in & Bump-out	\$1,600/hour (if extra time required)
Sunday & Monday	9.00am - 10.00pm
4 Hour Duration	\$6,000
8 Hour Duration	\$9,600
Bump-in & Bump-out	\$1,600/hour (if extra time required)
Gallery re-hang	\$1,500

The above rates do not include changes to the gallery's exhibition schedule. If you require access to the walls to display your content we can arrange this but require an additional charge.

Gallery Hours 10.00am - 5.00pm

The gallery is available for hire during this time, but will incur a surcharge if we have to close the gallery to the public. | Apply for rates.



size	49 m2
standing capacity	50 people
wall height	365 cm
lighting height	300 cm

GALLERY TWO

EVENT VENUE HIRE

TIMING & COST

Tuesday - Saturday	10.00am - 10.00pm
4 Hour Duration	\$3,000
8 Hour Duration	\$5,000
Bump-in & Bump-out	\$750/hour (if extra time required)

Sunday & Monday	9.00am - 10.00pm
4 Hour Duration	\$4,500
8 Hour Duration	\$8,000
Bump-in & Bump-out	\$660/hour (if extra time required)

Gallery re-hang	\$1,500
-----------------	---------

The above rates do not include changes to the gallery's exhibition schedule. If you require access to the walls to display your content we can arrange this but require an additional charge.



size	49 m2
standing capacity	50 people
wall height	365 cm
lighting height	300 cm

GALLERY TWO EXHIBITION VENUE HIRE TIMING & COST

Gallery Two is ideal for hosting art exhibitions. The size of the space is flexible and can be extended at extra cost upon request. Gallery One is only available for a single night event. Prices include freshly prepped walls, ready to install.

Weekend Hire

Bump-in	Friday
Saturday & Sunday	10.00am - 5.00pm
Bump-out	Monday
Total	\$12,000

Five Day Hire

Bump-in	Monday
Tuesday - Saturday	10.00am - 5.00pm
Bump-out	Monday
Total	\$16,000



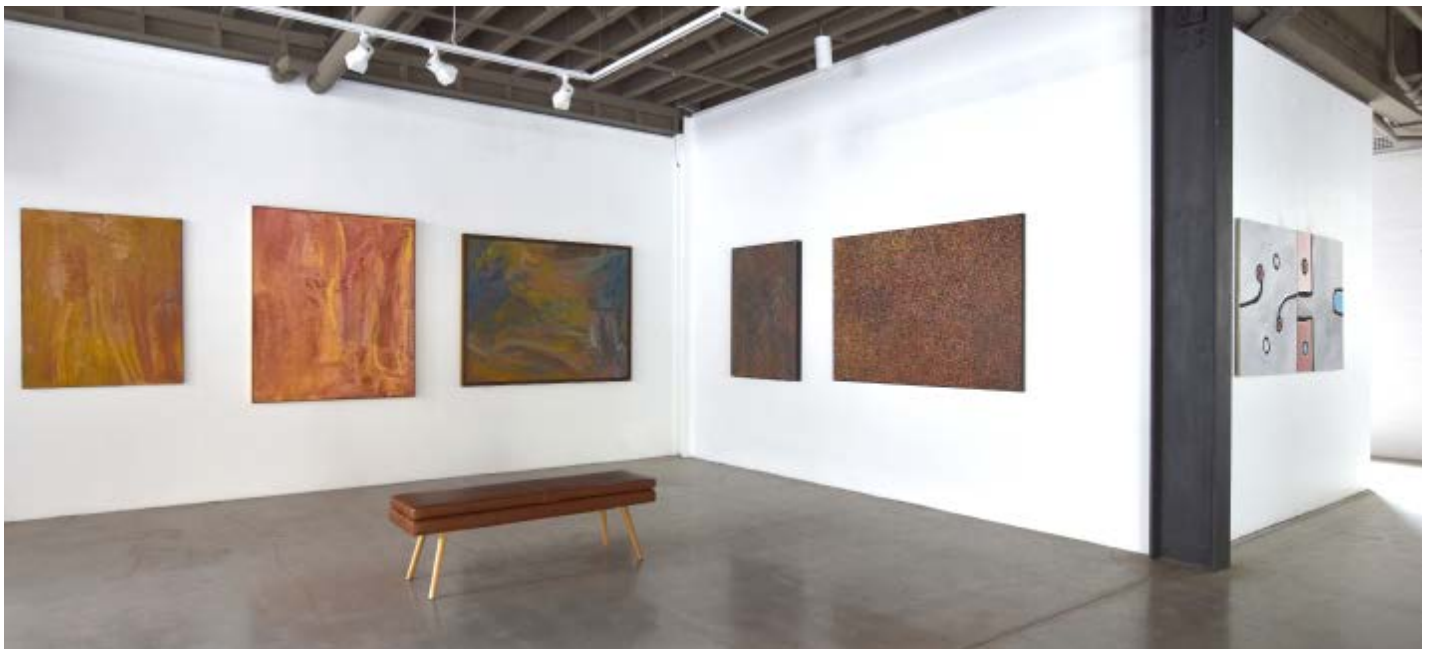

gallery two exhibition



gallery one exhibition

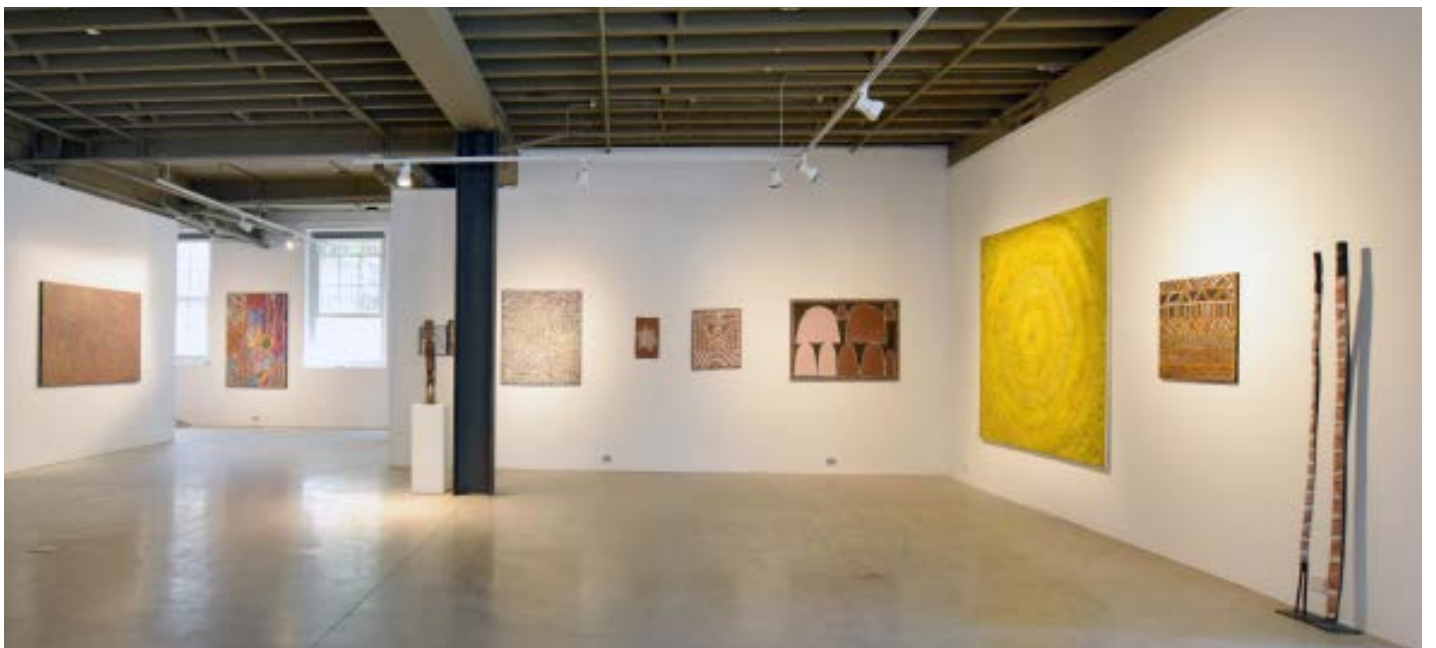

gallery one exhibition



gallery one from the outside at night



gallery two weaving workshop



gallery one and two



TERMS & CONDITIONS

The venue is to be left in the condition it was presented in. Used gallery property must be cleaned and put away. Hired equipment must be removed before the end of the rental period unless agreed before hand.

The Stockroom & Office Space are off limits to all guests. The gallery staff will go over which spaces can not be accessed, and these are to be left clear of people.

Equipment can be stored if need be, but only after discussing with the staff beforehand.

Non-Refundable holding deposit of 20% to secure the dates is due within 30 days of quote date. Balance due 30 days before event start date. If you need to cancel your event for any reason, you will receive a full refund less the holding deposit within 48 hours of cancelation. However, if you cancel your event within the last 24 hours, you will not be entitled to a refund.

There is a \$5,000 Insurance/Security deposit due 72 hours before the event which will be refunded within 48 hours after the event.

If any fire alarms are triggered a call out fee may be changed by NSW Fire & Rescue which will be passed on to the hiring entity.

A kitchenette is available for use. No cooking is to be done on-site.

LOCATION

Ground Floor
17 Thurlow Street
Redfern NSW 2016

CONTACT

Hayley Cotton
Gallery Manager
gallery@artleven.com.au

■ +61 (02) 9300 9233
■ www.artleven.com
■ @art.leven
■ #cooeeartleven

